

# Fframwaith Adfywio Strategol Canol Y Dref

## Town Centre Strategic Regeneration Framework

### Aberdaugleddau

Charles Street yw'r brif stryd yn Aberdaugleddau, ac mae yno amrywiaeth o siopau, arcedau bychan a gwasanaethau lleol. Y tu allan i ganol y dref, mae asedau pwysig fel Marina Aberdaugleddau a Pharc Siopa Havens Head, sy'n cynnwys nifer o siopau sy'n denu cwsmeriaid o'r stryd fawr.

Ym mhen gorllewinol canol y dref mae Theatr y Torch, ac mae'n nodwedd bwysig a llwyddiannus iawn yn y dref, sy'n denu ymwelwyr o ardal eang. Mae cyfleoedd i adnewyddu Charles Street a chreu gweli cysylltiadau ar gyfer Marina Aberdaugleddau.

#### Cwestiynau i'w hystyried:

- Beth fyddai ei angen ar Charles Street er mwyn bod yn stryd fawr llwyddiannus a llewyrchus?
- Sut gall canol y dref wella'r cysylltiadau â Theatr y Torch a'i chefnogi?
- Beth ddylid ei wneud i leihau nifer y siopa gwag?
- Sut gellid gwella'r cysylltiadau â Marina Aberdaugleddau?

### Milford Haven

Milford Haven's high street is centred on Charles Street and includes a range of retailing, small arcades and local services. Outside the core town centre are key assets such as Milford Marina and Havens Head Retail Park, which have a considerable quantity of retailing, drawing consumers away from the high street.

The Torch Theatre is at the western end of the town centre and is an important and successful feature of the town, drawing visitors from a wide area. There are opportunities for the renewal of Charles Street and improved links to the Milford Marina.

#### Questions to consider:

- What would Charles Street need to be a successful and vibrant high street?
- How can the town centre improve links with and support the Torch Theatre?
- What should be done to reduce the number of vacant shops?
- How can the links to the Milford Marina be improved?

#### Aberdaugleddau

##### 1. Sgwâr y Theatr

- Creu man agored amibwrpas newydd
- Gwaith gwella arwyneb wrysau cylagos, e.e. murlun addurniadol
- Cyffe i gael clog / catfis ar y sgwâr
- Cadw rhywfaith o'r llefydd parcio.

##### 2. Theatr y Torch/Canolfan Ddiwylliannol

- Gwaith gwella arwyneb Theatr y Torch gan gynnwys golau arbennig ac arwyddion ar gyfer y brigdwr
- Ailwampio adeiladau presennol y Cei i greu canolfan ddiwylliannol newydd
- Cysylltiad newydd i gerddwyr (grisiau a lifft) rhwng Theatr y Torch a'r Ganolfan Ddiwylliannol
- Datblygu gwasanaeth arfaethedig archebu o'r car Costa Coffee

##### 3. Marine Terrace (Marina)

- Datblygu tir i'r gogledd o Nelson Quay fel sydd wedi'i nodi ar uwch gynllun Glannau Aberdaugleddau ar gyfer defnydd preswyl, masnachol a hamdden
- Ymestyn a datblygu gerddi Marine Terrace gyda gweli cysylltiadau i gerddwyr (grisiau a lifft) at y glannau a chyffe i gael defnydd masnachol a gweithredol eraill ochr yn ochr â hyn
- Neu, defnyddio Marine Gardens i gysylltu'r marina a Hamilton Terrace drwy gael cysylltiadau i gerddwyr (grisiau a lifft).

#### Milford Haven

##### 1. Theatre Square

- Creation of a new multi-purpose open space
- Facelift works to adjacent warehouses e.g. decorative mural
- Scope for kiosk / café units on the square
- Retention of some surface car parking.

##### 2. Torch Theatre / Cultural Centre

- Face lift works to Torch Theatre including feature lighting and signage to fly-tower
- Refurbishment of existing Quay stores for new cultural centre
- New pedestrian link (stairs and lift) between Torch Theatre and Cultural Centre
- Development of proposed Costa Coffee drive-thru.

##### 3. Marine Terrace (Marina)

- Development of land north of Nelson Quay as identified in Milford Waterfront masterplan for residential, commercial, and leisure uses
- Expansion and development of Marine Terrace gardens with enhanced pedestrian links (stairs and lift) to waterfront and scope for commercial and other active uses alongside
- Alternatively, create Marine gardens to link marina and Hamilton Terrace through pedestrian links (stairs and lift).





# Prosiectau Blaenllaw Aberdaugleddau

## Milford Haven Flagship Projects

### Aberdaugleddau

**Mae'r Prosiectau Blaenllaw isod wedi'u dynodi'n gynlluniau allweddol ar gyfer canol y dref, yn dilyn cyfnod o ymgynghori. Eu bwriad yw gwella neu adnewyddu canol y dref yn sylweddol.**

### Milford Haven

The below Flagship Projects have been identified through consultations as being key schemes for the town centre. They are intended to provide a significant renewal or enhancement of the town centre.

#### Aberdaugleddau

##### 1. Sgwâr y Theatr

- Creu man agored amibwrpas newydd
- Gwalth gwella arwyneb waysau cyfagos, e.e. murlun adduniadol
- Cyfle i gael clog / caffis ar y sgwâr
- Cadw rhywfaint o'r llefydd parcio.

##### 2. Theatr y Torch/Canolfan Ddiwylliannol

- Gwalth gwella arwyneb Theatr y Torch gan gynnwys golau atbenning ac arwyddion ar gyfer y brigdwyr
- Ailwampio adeiladau presennol y Cei i greu canolfan ddiwylliannol newydd
- Cysylltiad newydd i gerddwyr (grisiau a lifft) rhwng Theatr y Torch a'r Ganolfan Ddiwylliannol
- Datblygu gwasanaeth arfaethedig archebu o'r car Costa Coffee

##### 3. Marine Terrace (Marina)

- Datblygu tir i'r gogledd o Nelson Quay fel sydd wedi'i nodi ar uwchynllun Glannau Aberdaugleddau ar gyfer defnydd preswyl, masnachol a hamdden
- Ymestyn a datblygu gerddi Marine Terrace gyda gwail cysylltiadau i gerddwyr (grisiau a lifft) at y glannau a chyfle i gael defnydd masnachol a gweithredol eraill ochr yn ochr â tyn
- New, defnyddio Marine Gardens i gysylltu'r marina a Hamilton Terrace drwy gael cysylltiadau i gerddwyr (grisiau a lifft).

#### Milford Haven

##### 1. Theatre Square

- Creation of a new multi-purpose open space
- Facelift works to adjacent warehouses e.g. decorative mural
- Scope for kiosk / café units on the square
- Retention of some surface car parking.

##### 2. Torch Theatre / Cultural Centre

- Face lift works to Torch Theatre including feature lighting and signage to fly-tower
- Refurbishment of existing Quay stores for new cultural centre
- New pedestrian link (stairs and lift) between Torch Theatre and Cultural Centre
- Development of proposed Costa Coffee drive-thru.

##### 3. Marine Terrace (Marina)

- Development of land north of Nelson Quay as identified in Milford Waterfront masterplan for residential, commercial, and leisure uses
- Expansion and development of Marine Terrace (Marina) gardens with enhanced pedestrian links (stairs and lift) to waterfront and scope for commercial and other active uses alongside
- Alternatively, create Marine gardens to link marina and Hamilton Terrace through pedestrian links (stairs and lift).

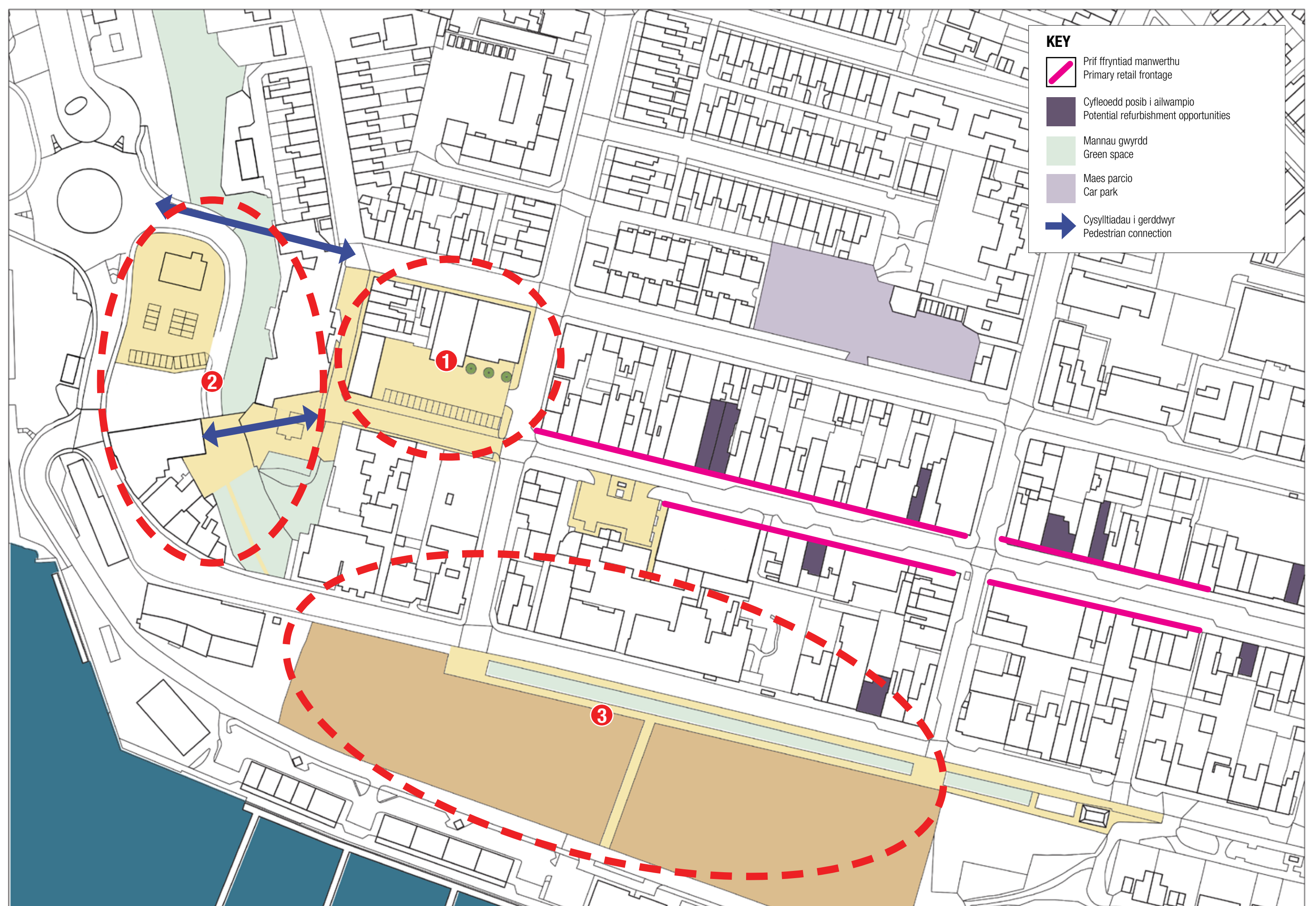

Moderna Museet Square, Malmö

Arts Centre, San Francisco

Marlow Theatre, Canterbury

Craft and Design Centre, Manchester

Proposed scheme, Milford Waterfront